



CADWorx® Structure Professional

Efficiently create fully intelligent, 3D structural designs

Capabilities:

- Intelligent 3D Steel and Concrete Design
- Member Modeling
- Plate Modeling
- Footing and Foundation Modeling
- Slab and Wall Modeling
- Connection Modeling
- Stairs, Ladders and Hand Rail Arrangements
- Decking and Grating Modeling
- Coping and Mitering
- International Steel Libraries
- Bills of Material
- 2D Output Linked to 3D Model
- Data Interoperability for Structural Analysis/Detailing
- Weight and Center of Gravity
- Assembly Templates
- Flexible Selection Filtering
- Clash Detection

CADWorx Structure Professional includes the critical tools you need for effective structural design to help reduce the work-hours needed to create your structural projects. Workflows have been built into the design of the software that aid in producing revenue-earning deliverables more quickly and accurately.

Time-saving 3D modeling

Create fully intelligent, 3D structural models with the unparalleled flexibility and collaboration of a DWG-based system. Choose shapes or assemblies from a diverse library and use grid systems to accurately build your structures and communicate project layouts.

Comprehensive steel shape catalogs

International catalogs of steel shape libraries in both imperial and metric units are included with CADWorx Structure Professional, providing the necessary steel shapes for accurately representing steel members in your 3D model. Historical and modern country-specific steel manuals can be added quickly when your company enters new markets.

Easy-to-place assemblies

Some of the more detailed work in a structure includes adding secondary steel for access control, and CADWorx Structure Professional provides commands for effortless modeling of these objects. Whether your project includes industry standards or your company has developed its own standard, CADWorx Structure Professional allows the designer to replicate the necessary arrangement of these traffic items. Many customization options are built in so that these assembly objects can reflect the scenarios encountered in industrial applications. Grating and decking can be rendered to visualize accurate portrayals of these objects in your 3D model.

Drawings

Designers and engineers can easily create 2D drawings of their 3D models with native dimensioning and annotations. Typical general arrangement drawings include single linesteeel and 2D representations that support multiple views.

Reuse your structural model

Why spend hours recreating your structural model in order to analyze your structure? Using an industry standard import/export format, the designer can export the structural model to a structural analysis package such as GT STRUDL®, saving many hours of rework. Similarly, a designer can export the model to send to a structural detailing contractor and continually update the contractor as changes occur. Any modifications by the engineer or detailer can then be re-imported into the CADWorx Structure Professional model for clash detection.

Bills of material

Users can create accurate, user-configurable bills of material in the most popular database formats for all of their steel materials in the 3D model. These reports can be used to show total lengths and weights for each size, cut lengths and selected object lengths and weights.

Technical specifications

- AutoCAD®-compatible
- BricsCAD®-compatible (Recommended)

Application areas

Process and Plant Design, Piping, Equipment, Steelwork, Petrochemical, Chemical, Power, Offshore, Food, Beverage, Brewing, Pharmaceutical, Semiconductor, Water Treatment, Building Services and Shipbuilding.

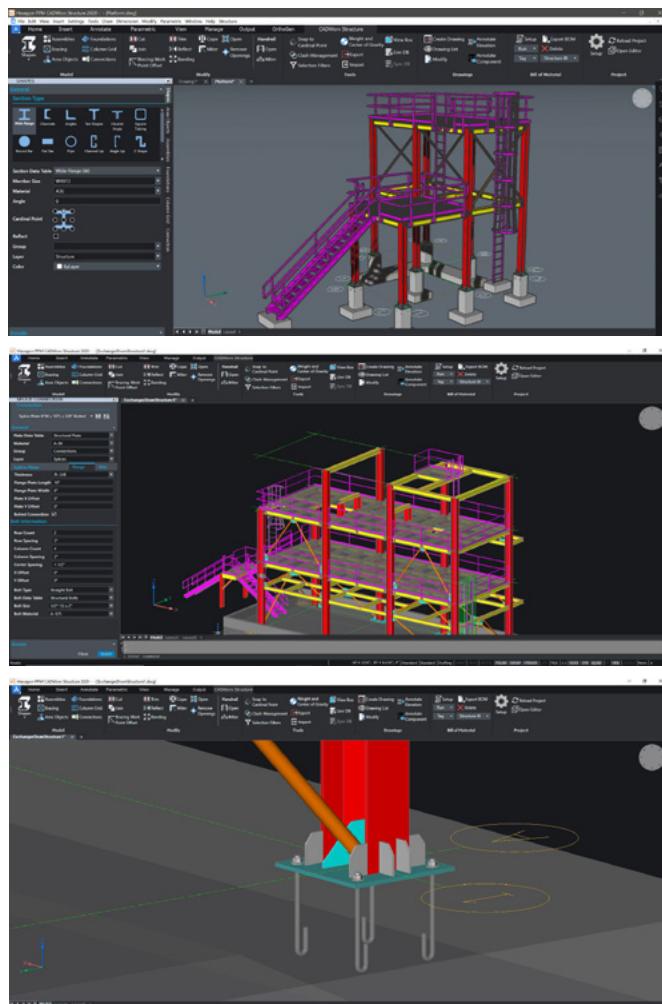

About Hexagon

Hexagon is the global leader in digital reality solutions, combining sensor, software and autonomous technologies. We are putting data to work to boost efficiency, productivity, quality and safety across industrial, manufacturing, infrastructure, public sector, and mobility applications.

Hexagon's Asset Lifecycle Intelligence division helps clients design, construct, and operate more profitable, safe, and sustainable industrial facilities. We empower customers to unlock data, accelerate industrial project modernization and digital maturity, increase productivity, and move the sustainability needle.

Our technologies help produce actionable insights that enable better decision-making and intelligence across the asset lifecycle of industrial projects, leading to improvements in safety, quality, efficiency, and productivity, which contribute to Economic and Environmental Sustainability.

Hexagon (Nasdaq Stockholm: HEXA B) has approximately 24,000 employees in 50 countries and net sales of approximately 5.5bn USD. Learn more at [hexagon.com](https://www.hexagon.com) and follow us [@HexagonAB](https://twitter.com/HexagonAB).